

OPEN FIREPLACES FROM BRUNNER



Urfeuer® 50/66

State: 2018-08-17



BRUNNER®
made in germany.

Dimension sheets - Urfeuer® 50/66

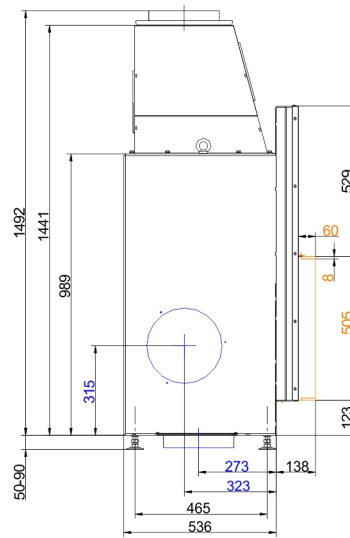
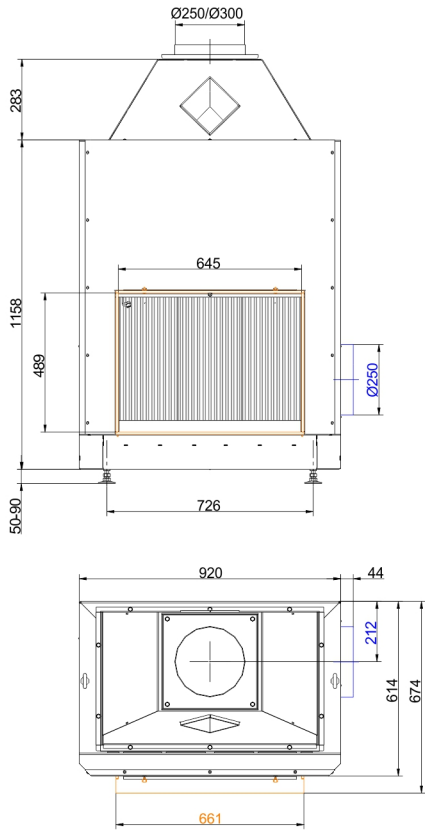

... with mounting frame

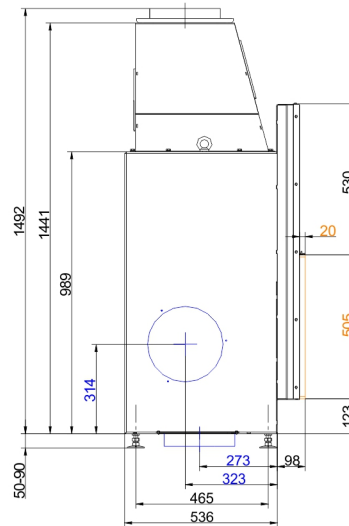
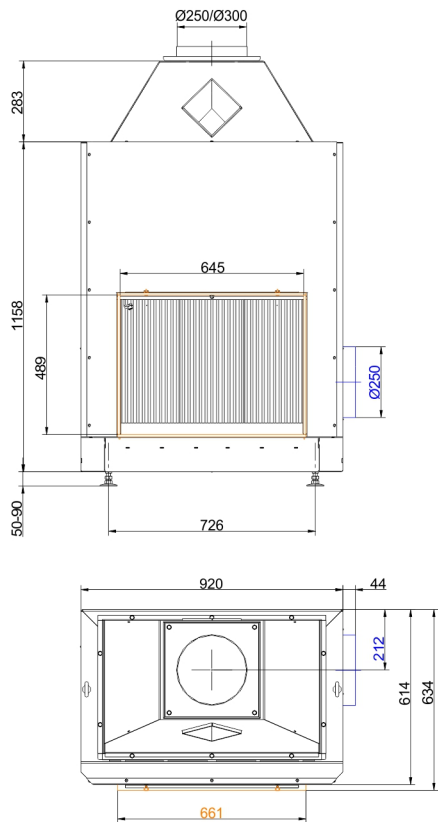

... mounting frame

Dimension sheets - Urfeuer® 50/66

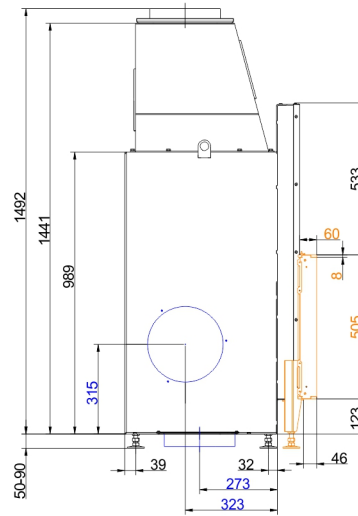
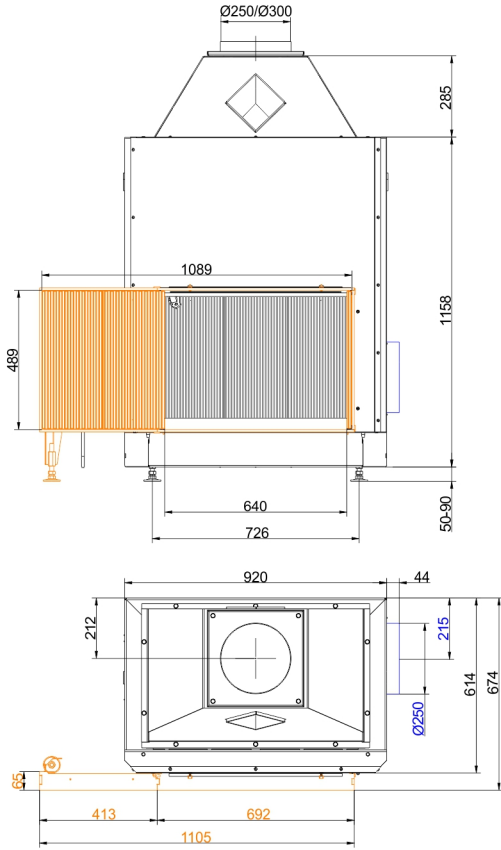

... with mounting frame L2

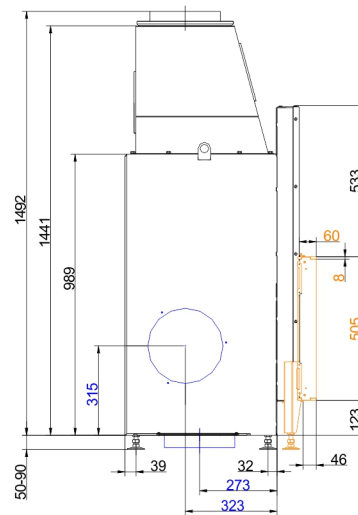
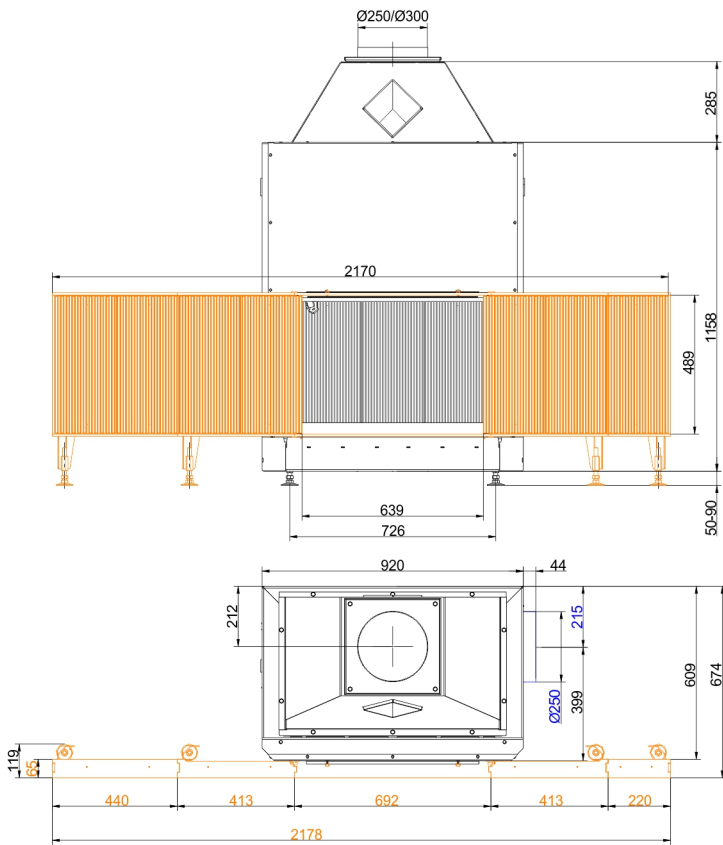

... with mounting frame L4 / R3

We suggest for CAD planing Palette CAD. Permanent updated drawings: www.brunner.de
 Frames / front versions are marked colored.

Planning and installation - Urfeuer® 50/66

| | | |
|---|------|---------------|
| Tested according to | | EN 13229 W |
| EEI | | 53.5 |
| Data for functional demonstration | | |
| Flue gas mass flow | g/s | 115 |
| Outlet temperature | °C | 115 |
| Necessary supply pressure | Pa | 6 |
| Total fuel load | kg | 2 - 4 |
| Combustion air consumption | m³/h | 212 |
| Combustion air connection Ø | mm | 250 |
| Cross-section of gratings | | |
| Convection air | cm² | 500 |
| Supply air | cm² | 500 |
| Min. distances of fireplace without / with convection casing | | |
| to insulation layer | cm | 6 |
| to mounting floor | cm | 2.5 |
| Thermal insulation without / with air gratings | | |
| Mounting wall | cm | 10 |
| Ceiling | cm | 14 |
| Brick lining for combustible wall | cm | 10 |
| Weight | | |
| Fireplace / combustion chamber | kg | 213 / 112 / - |

Ulrich Brunner GmbH
Zellhuber Ring 17 - 18
D-84307 Eggenfelden
Telefonat: +49 / (0)87 21 / 7 71-0
Telefax: +49 / (0)87 21 / 7 71-100
info@brunner.de | www.brunner.de

BRUNNER®
made in germany.